

***Transport trailers
for small milling machines
Technical specification***





Contents

***Transport trailer T 89 W
for the cold milling machines
W 35 / W 35 DC, W 350 / W 350 E
and W 50 without conveyor***

Page 4

***Transport trailer T 119 W
for the cold milling machines W 500,
W 50 and W 50 DC***

Page 6

***Transport trailer T 119 LW
for the cold milling machines W 500,
W 50 and W 50 DC***

Page 8

***Transport trailer ZT 200
for the cold milling machines W 600 DC
and W 1000 L***

Page 10

Transport trailer T 89 W for milling machines W 35, W 35 DC, W 350, W 350 E and W 50 without conveyor

Dimensions in mm

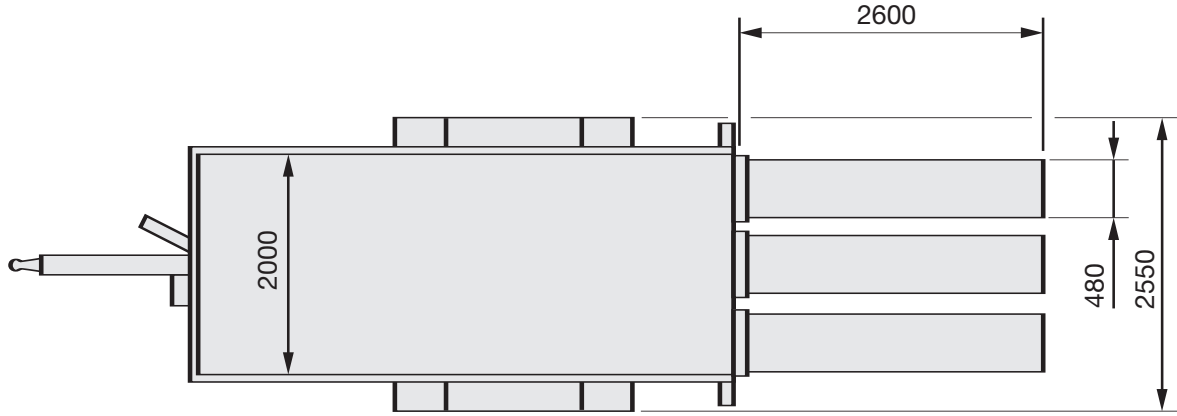
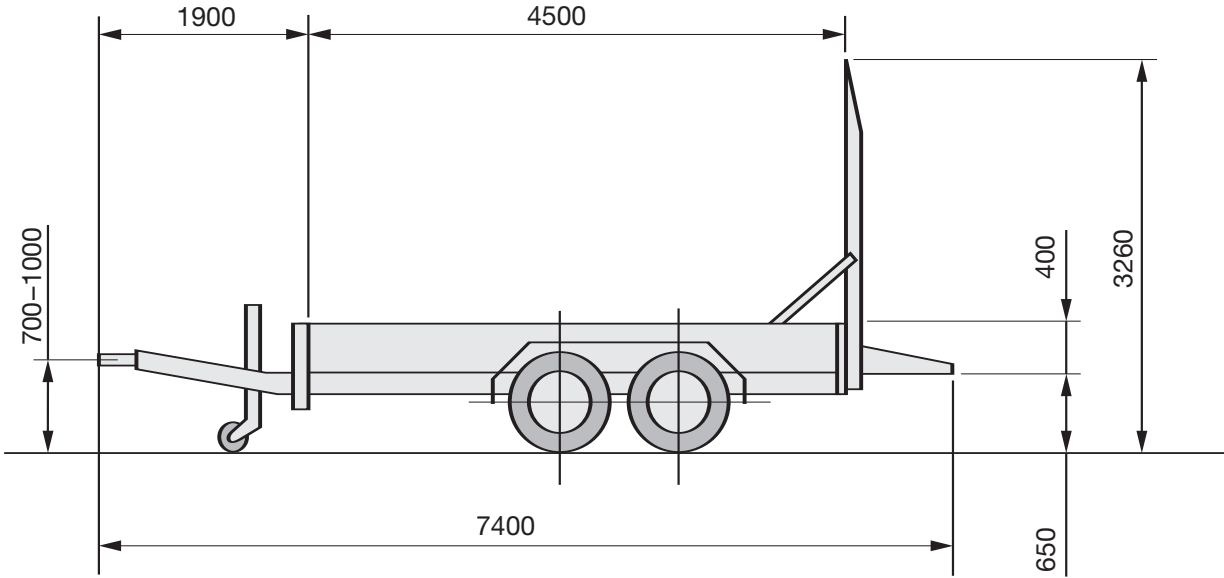

Alternatively: 2 loading ramps

Technical data transport trailer T 89 W

Permissible maximum weight	kg	8,900
Permissible drawbar load	kg	500
Payload with standard equipment, including drawbar load, approx.	kg	6,250
Loading angle	°	14.5
Overall height, approx.	mm	3,250
Tyres		215/75 R 17.5
No. of wheels / bolts	Pcs.	4 / 6

Additional equipment changes empty weight and payload.

Chassis

Robust low-bed main frame made of high-quality welded steel profiles, resistant to bending and distortion, without recesses impairing stability, front and side walls made of reinforced steel profiles, reinforced bridge floor made of 5 mm studded steel plate, lashing points in the corners.

Axles, tyres and wheels

High-speed axle with precision tapered roller bearings, sealed S-cam brakes, automatic brake slack adjuster, disk wheels with fourfold low-loader tyres, supplied with spare wheel.

Axle assembly and suspension

Low-maintenance tandem assembly for optimum load distribution, carefully tuned spring suspension, 80 mm wide.

Drawgear

Central tube with threaded drawbar eye in accordance with DIN standards, 40 mm diameter, continuously adjustable in height with spindle adjusting mechanism.

Brake system

Dual-line all-wheel air brake in accordance with EC directives, including release valve, automatic load-controlled brake, four diaphragm cylinders, test connections, connecting

hoses with non-interchangeable hose couplings, screw-type parking brake acting on the front axle, automatic anti-lock braking system (ABS).

Electrical system

24 V, splash-proof 4-compartment light with integrated rear fog light, bracket for double-line registration number, lateral reflectors and position lights, clearance lights and 2 x 7-pole connecting cables in accordance with DIN ISO 1185 and DIN ISO 1724.

Supports

Screw-type support at the front, with two gear settings for travel under load and high-speed travel; invariable supports mounted at the rear of the ramps.

Ramps

Three one-piece ramps consisting of parallel longitudinal beams with cross-bars, tapered ramp ends, ramps lined with galvanized 30 x 30 mm grating to increase stability and reduce wind resistance. Adjustable closure with zero clearance, one-man handling.

Painting

Steel parts stove-finished with high-quality acrylic paint in one colour, RAL 9001 (cream-white), special painting upon request. Wheel rims silver.

Accessories

Two wheel chocks with mounts, brackets for spare wheel underneath the trailer floor, vehicle registration documents and test logbook.

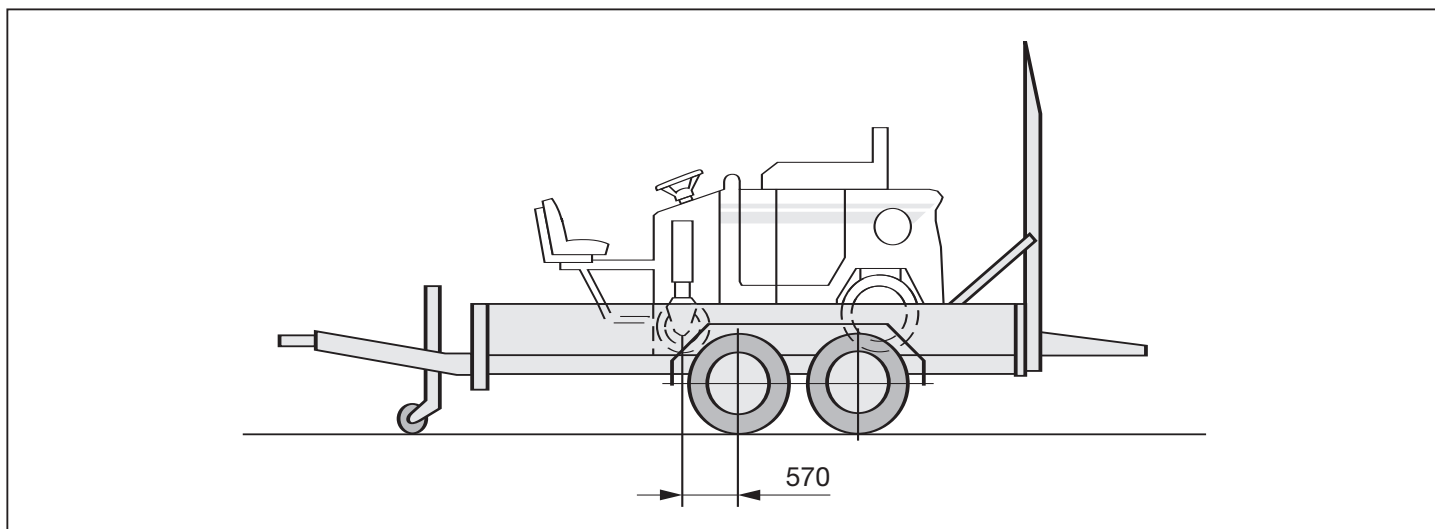

Transport trailer T 119 W for the cold milling machines W 500, W 50 and W 50 DC

Dimensions in mm

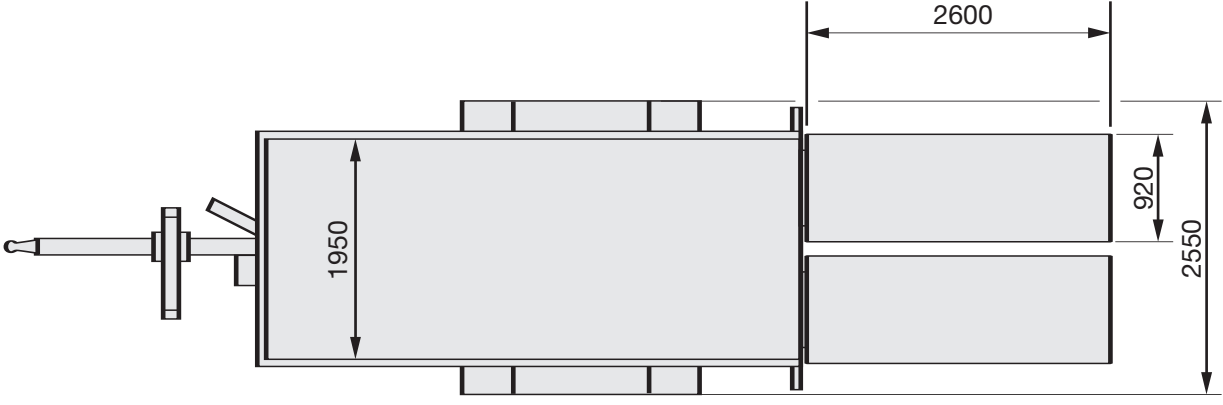
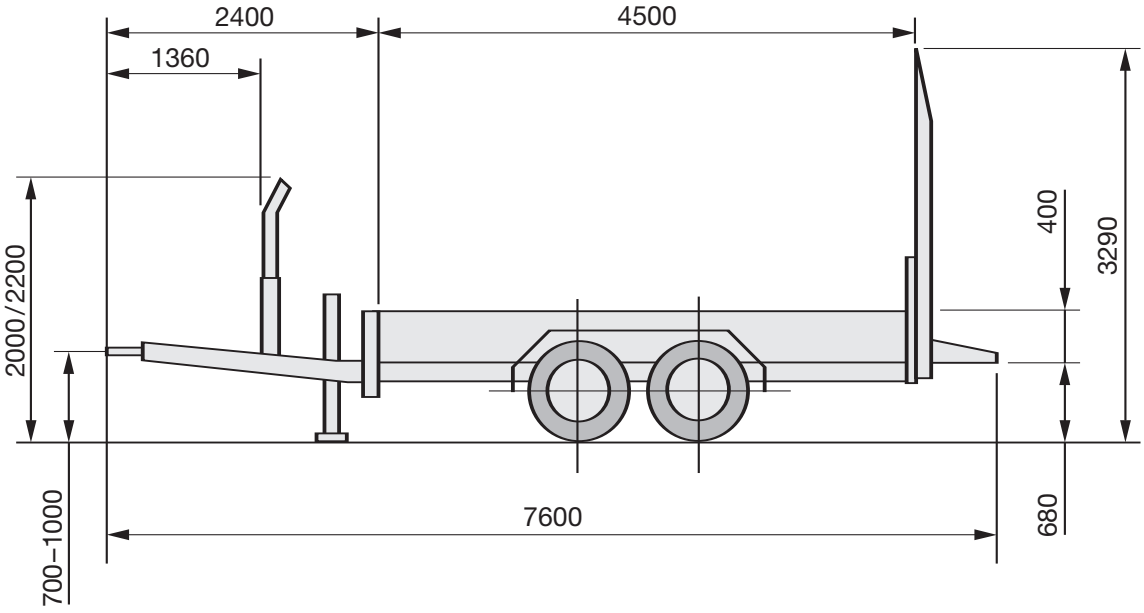

Technical data transport trailer T 119 W

Permissible maximum weight	kg	11,900
Permissible drawbar load	kg	1,000
Payload with standard equipment, including drawbar load, approx.	kg	9,000
Loading angle	°	15
Overall height, approx.	mm	3,290
Tyres		235/75 R 17.5
No. of wheels / bolts	Pcs.	4 / 6

Additional equipment changes empty weight and payload.

Chassis

Robust low-bed main frame made of high-quality welded steel profiles, resistant to bending and distortion, without recesses impairing stability, front and side walls made of reinforced steel profiles, reinforced bridge floor made of 5 mm studded steel plate, lashing points in the corners.

Axles, tyres and wheels

High-speed axle with precision tapered roller bearings, sealed S-cam brakes, automatic brake slack adjuster, disk wheels with fourfold low-loader tyres, supplied with spare wheel.

Axle assembly and suspension

Low-maintenance tandem assembly

for optimum load distribution, carefully tuned spring suspension, 70 mm wide.

Drawgear

Central tube with threaded drawbar eye in accordance with DIN standards, 40 mm diameter, continuously adjustable in height with spindle adjusting mechanism.

Brake system

Dual-line all-wheel air brake in accordance with EC directives, including release valve, automatic load-controlled brake, four diaphragm cylinders, test connections, connecting hoses with non-interchangeable hose couplings, screw-type parking brake acting on the front axle, automatic anti-lock braking system (ABS).

Electrical system

24 V, splash-proof 4-compartment light with integrated rear fog light, bracket for single-line registration number, lateral reflectors and position lights, clearance lights and 2 x 7-pole connecting cables in accordance with DIN ISO 1185 and DIN ISO 1724.

Supports

12-ton landing gear at the front, with two gear settings for travel under load and high-speed travel; invariable supports mounted at the rear of the ramps, twofold adjustable support for loading conveyor, mounted on drawbar.

Ramps

Two one-piece ramps consisting of parallel longitudinal beams with crossbars, tapered ramp ends, ramps lined with galvanized 30 x 30 mm grating to increase stability and reduce wind resistance. Fastened on both sides by cam-type closure, one-man handling.

Painting

Steel parts stove-finished with high-quality acrylic paint in one colour, RAL 9001 (cream-white), special painting upon request. Wheel rims silver.

Accessories

Two wheel chocks with mounts, brackets for spare wheel underneath the trailer floor, vehicle registration documents and test logbook.

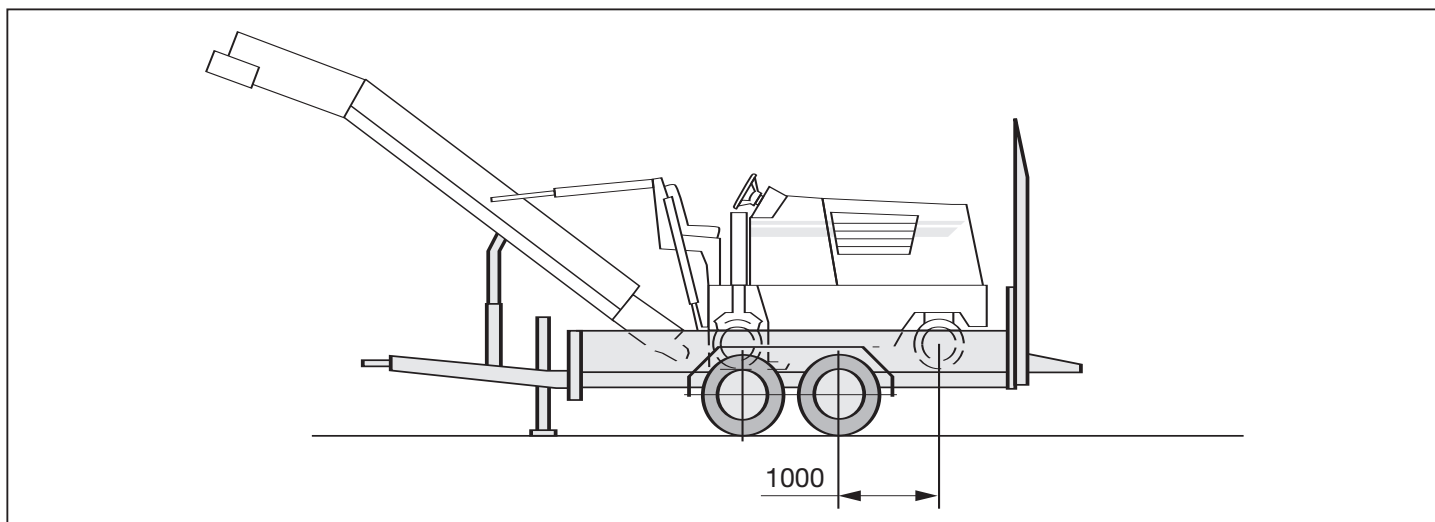

Transport trailer T 119 LW for the cold milling machines W 500, W 50 and W 50 DC

Dimensions in mm

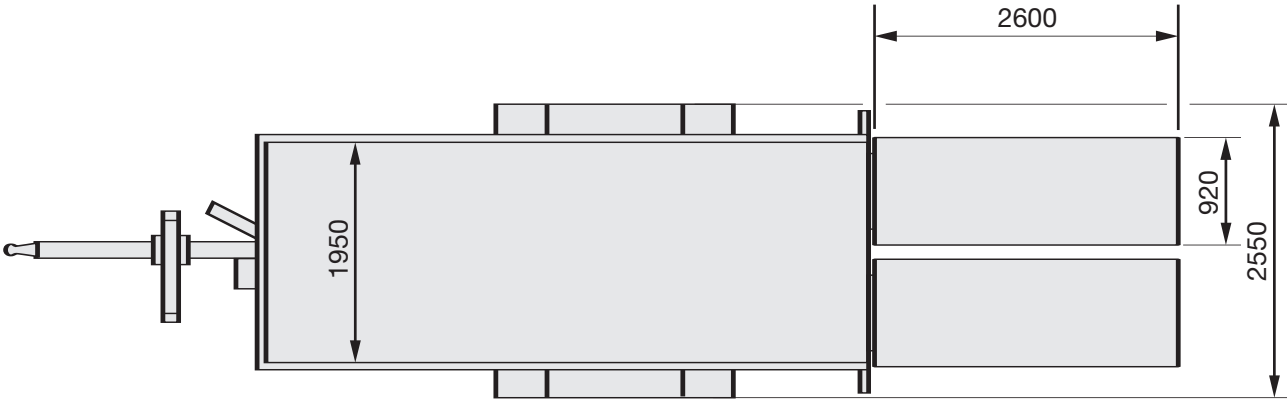
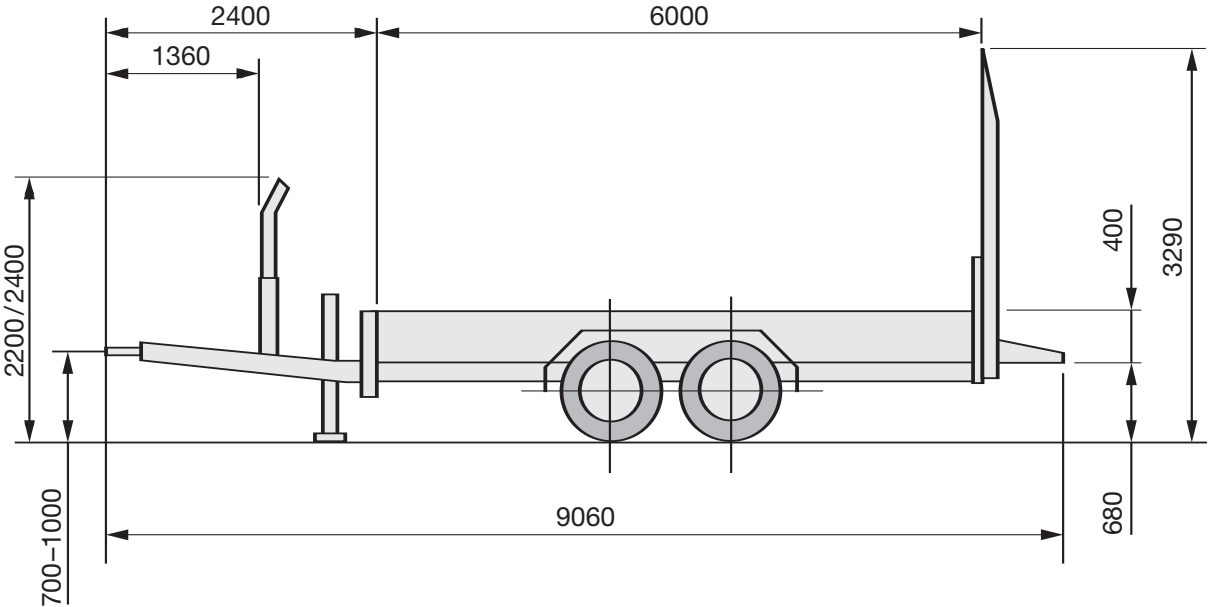

Technical data transport trailer T 119 LW

Permissible maximum weight	kg	11,900
Permissible drawbar load	kg	1,000
Payload with standard equipment, including drawbar load, approx.	kg	9,000
Loading angle	°	15
Overall height, approx.	mm	3,300
Tyres		235/75 R 17.5
No. of wheels / bolts	Pcs.	4 / 6

Additional equipment changes empty weight and payload.

Chassis

Robust low-bed main frame made of high-quality welded steel profiles, resistant to bending and distortion, without recesses impairing stability, front and side walls made of reinforced steel profiles, reinforced bridge floor made of 5 mm studded steel plate, lashing points in the corners.

Axles, tyres and wheels

High-speed axle with precision tapered roller bearings, sealed S-cam brakes, automatic brake slack adjuster, disk wheels with fourfold low-loader tyres, supplied with spare wheel.

Axle assembly and suspension

Low-maintenance tandem assembly

for optimum load distribution, carefully tuned spring suspension, 70 mm wide.

Drawgear

Central tube with threaded drawbar eye in accordance with DIN standards, 40 mm diameter, continuously adjustable in height with spindle adjusting mechanism.

Brake system

Dual-line all-wheel air brake in accordance with EC directives, including release valve, automatic load-controlled brake, four diaphragm cylinders, test connections, connecting hoses with non-interchangeable hose couplings, screw-type parking brake acting on the front axle, automatic anti-lock braking system (ABS).

Electrical system

24 V, splash-proof 4-compartment light with integrated rear fog light, bracket for single-line registration number, lateral reflectors and position lights, clearance lights and 2 x 7-pole connecting cables in accordance with DIN ISO 1185 and DIN ISO 1724.

Supports

12-ton landing gear at the front, with two gear settings for travel under load and high-speed travel; invariable supports mounted at the rear of the ramps, twofold adjustable support for loading conveyor, mounted on drawbar.

Ramps

Two one-piece ramps consisting of parallel longitudinal beams with crossbars, tapered ramp ends, ramps lined with galvanized 30 x 30 mm grating to increase stability and reduce wind resistance. Fastened on both sides by cam-type closure, one-man handling.

Painting

Steel parts stove-finished with high-quality acrylic paint in one colour, RAL 9001 (cream-white), special painting upon request. Wheel rims silver.

Accessories

Two wheel chocks with mounts, brackets for spare wheel underneath the trailer floor, vehicle registration documents and test logbook.

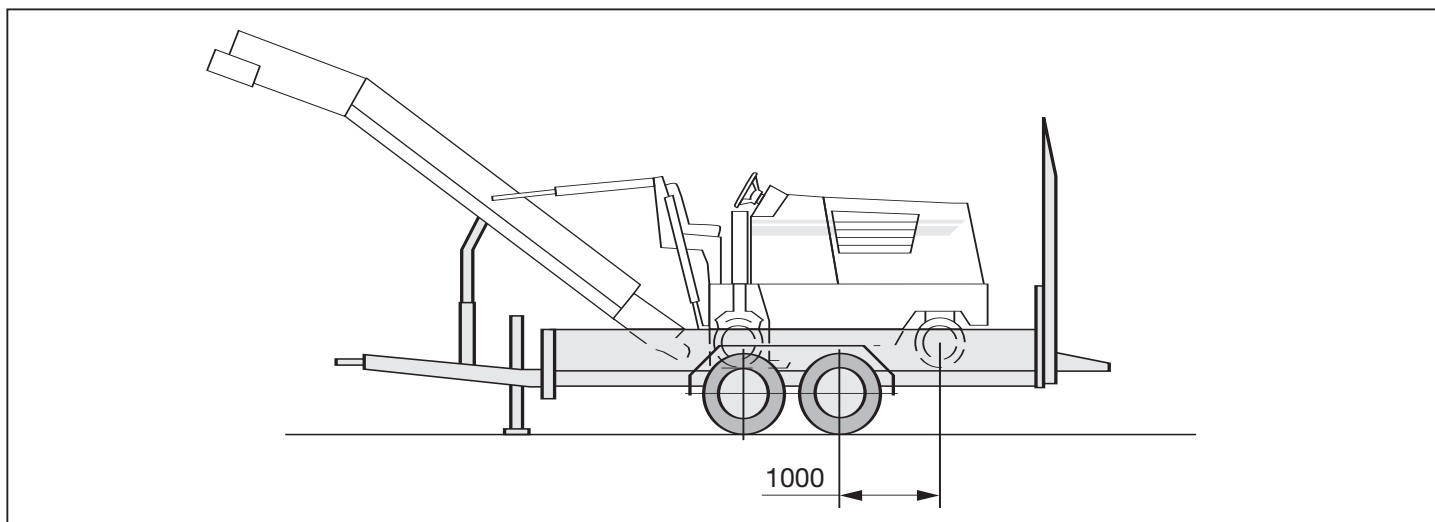

Transport trailer ZT 200 for the cold milling machines W 600 DC and W 1000 L

Dimensions in mm

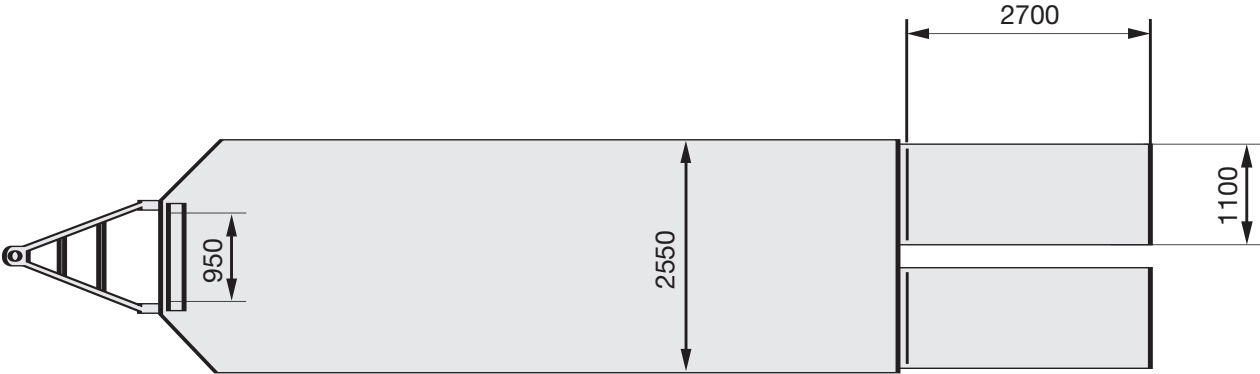
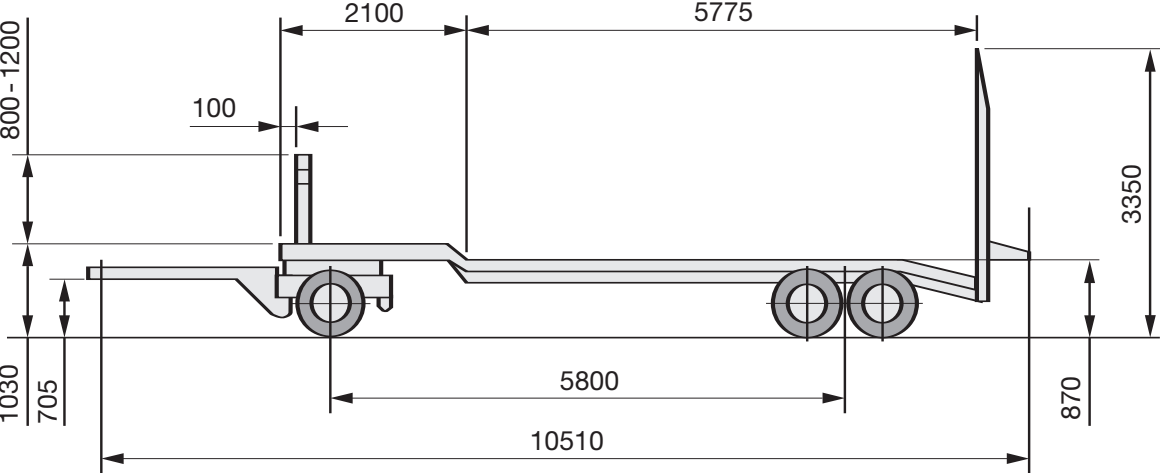

Technical description

Technical data transport trailer ZT 200

Permissible maximum weight	kg	20,000
Payload with standard equipment, including drawbar load, approx.	kg	15,950
Loading angle	°	13
Overall height, approx.	mm	3,350
Tyres		235/75 R 17.5
No. of wheels / bolts front	Pcs.	4/10
No. of wheels / bolts rear	Pcs.	4/6

Additional equipment changes empty weight and payload.

Chassis

Robust main frame made of high-quality welded double-T steel profiles with crossbars and gradually decreasing cranking, resistant to bending and distortion, without recesses impairing stability, with specially profiled side and bottom frame, reinforced bridge floor made of 50 mm wooden planks, drive-on wheel housings, 4 lashing points, 4 lashing straps on each side of the side frame.

Axles, tyres and wheels

High-quality axles with precision tapered roller bearings, sealed S-cam brakes, automatic brake slack adjuster, disk wheels with fourfold low-loader tyres, supplied with spare wheel.

Suspension

Low-maintenance, carefully tuned parabolic spring suspension, 80 mm wide.

Bogie and drawgear

Bogie made of robust steel profiles with high-quality ball-and-socket steering turnplate, type-tested drawbar with inclined drawbar eye, 40 mm diameter, drawbar spring of variable height; length of drawbar from front section 2,045 mm.

Brake system

Dual-line all-wheel air brake in accordance with EC directives, automatic load-controlled brake, six diaphragm cylinders, test connections, connecting hoses with non-interchangeable

hose couplings, low-maintenance screw-type parking brake acting on the rear axle, including hinged handle, automatic anti-lock braking system (ABS).

Electrical system

24 V, splash-proof and vibration-damped 9-compartment lights with integrated rear fog light and reversing light, bracket for single-line registration number, lateral reflectors, lateral position lights, clearance lights and 2 x 7-pole connecting cables in accordance with DIN ISO 1185 and DIN ISO 3731.

Ramps

One-piece ramps consisting of parallel longitudinal beams with crossbars, tapered ramp ends, ramps lined with wood. Gas-pressure ramp lift for one-man handling.

Painting

Steel parts stove-finished with high-quality acrylic paint in one colour, RAL 9001 (cream-white), special painting upon request. Wheel rims silver.

Accessories

Side impact protection with aluminium planks in accordance with EC standards, one wheel chock with mount, acceptance certificate by the German Technical Inspection Authority (TÜV), vehicle registration documents and test logbook.

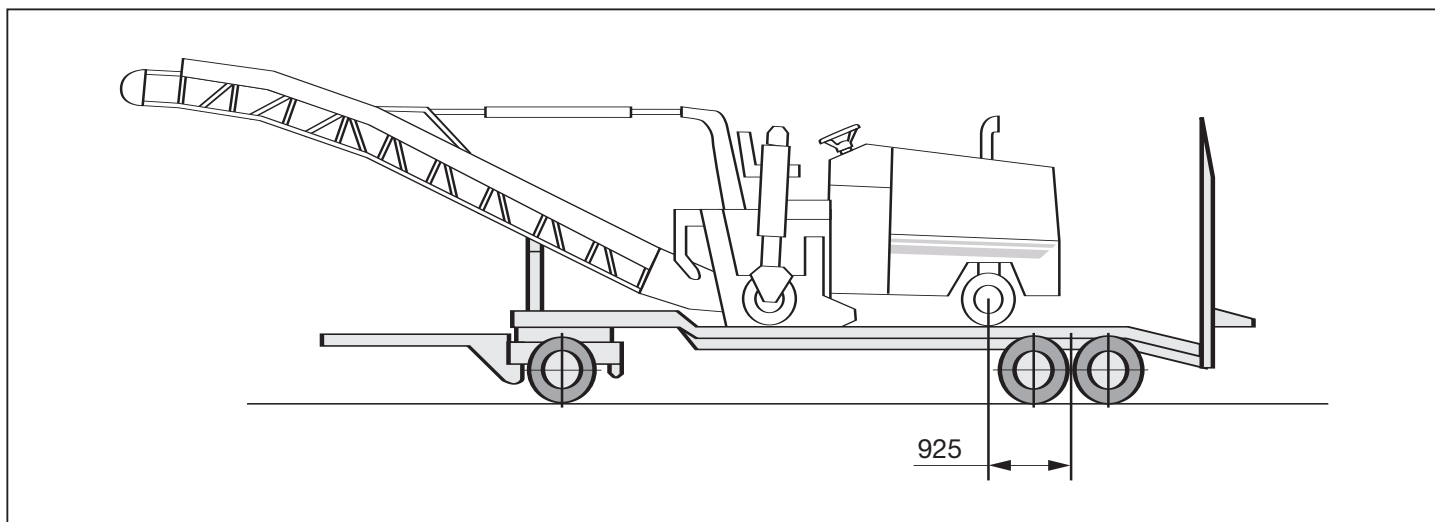



Wirtgen GmbH · Hohner Strasse 2
53578 Windhagen · Germany

Phone: +49 (0) 26 45 / 131-0

Fax: +49 (0) 26 45 / 131-242

Internet: www.wirtgen.com
